

# Garage Door Fitting Instructions

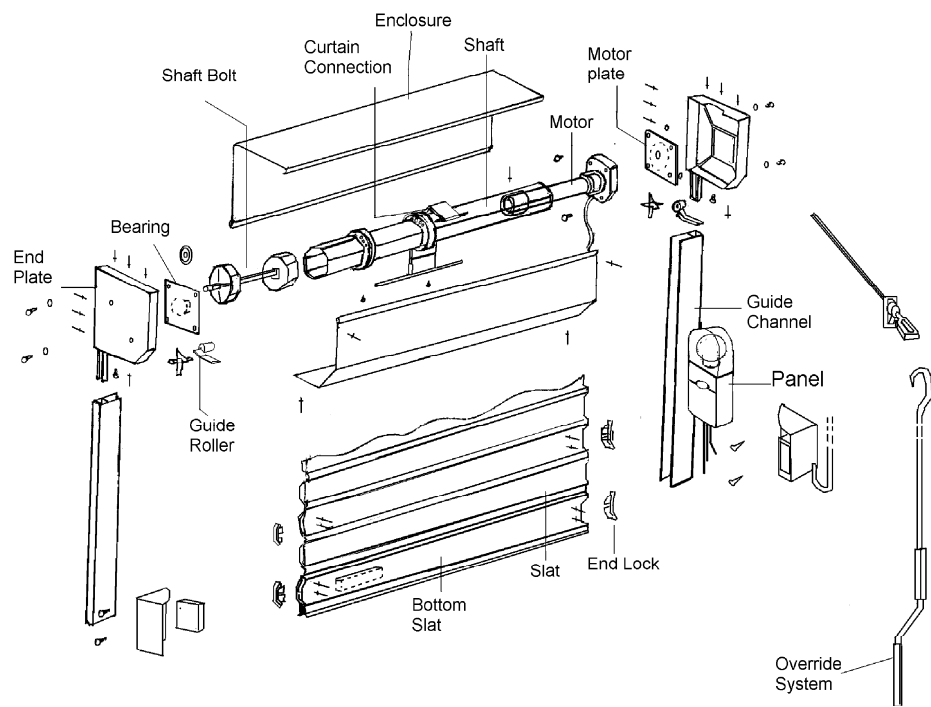

## **STEP 1 – TAKING DELIVERY AND CHECKING ALL PARTS**

Please check that the door is the correct size and all component parts are present. This garage door is heavy and awkward to handle, it is recommended that fitting this door is carried out by two people.

You should have:

- i) Box containing door curtain
- ii) Two guide rails
- iii) Box containing electronic controls
- iv) Manual over-ride equipment
- v) Motor barrel containing the motor

Ensure that the site is clear and that the fixing surfaces are free from loose plaster and masonry. Ensure that the opening has no irregularities that could damage the back box or curtain.

The door curtain will be fully packaged when delivered. The end plates will be factory fitted to the back box (if ordered) and the curtain will be rolled and packed inside. The two side channels (guide rails) should be unpacked and placed into either side of the opening. The guides are designed to slot into the end plates via the peg on the end plate.

## **STEP 2 – PREPARING THE MOTOR AND BACK BOX**

1. Carefully remove the box lid and place in a safe place, remove the curtain from the box and place on a **suitable surface that will not damage the curtain.**
2. The motor barrel is held in place by a captive bearing on the non-drive end and a mounting plate on the drive end. The non-drive end of the barrel has an adjustable shaft held in place with an Allen bolt. With a 6mm Allen key loosen the Allen bolt allowing the shaft to slide in and out of the motor barrel. (See Figure 1).

3. Using the two countersunk nuts and bolts supplied fit the barrel into position, making sure that the manual over-ride position on the motor is at the required point.

### **FIGURE 1 - MOTOR BARREL SECTION**

#### **NON DRIVE END**

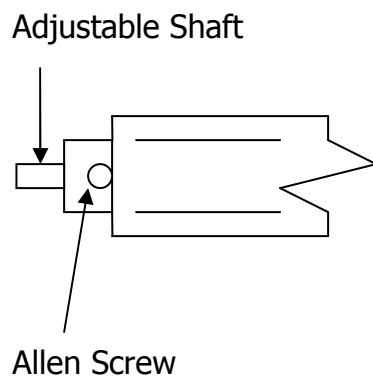

#### **DRIVEN END**

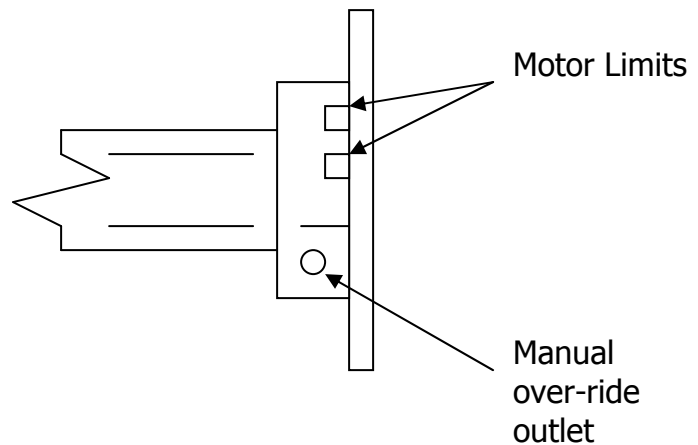

4. When you are happy that the motor barrel is installed in the correct way, tighten the motor plate and fully extend the sliding shaft into the free bearing at the non-drive end. Lock the shaft with an Allen key.

### **STEP 3 – PREPARING THE GUIDE RAILS**

1. Determine whether you are using 70mm or 90mm guides. 90mm guides are fitted with an extra thick grey brush strip that must be fitted in the inside (internal fit-inside of garage). 70mm guides are offset slightly to ensure alignment with the box. Slide the guide onto the end plate peg and check that the back of the box lines up with the back of the guide, mark guide accordingly.
2. Determine method of fitting guides, face fix (onto back of the brickwork) or reveal fix (between the brickwork). Drill 7mm fixing holes as per diagram,

enlarge inside holes to 10mm to accommodate plastic grommets. Easy Fit recommend at least four good fixings per guide. (See Figure 2).

3. File the inside of the guide channels – (at the top), to create a chamfered lead in for the curtain.

**FIGURE 2 – GUIDE RAILS DIAGRAM**

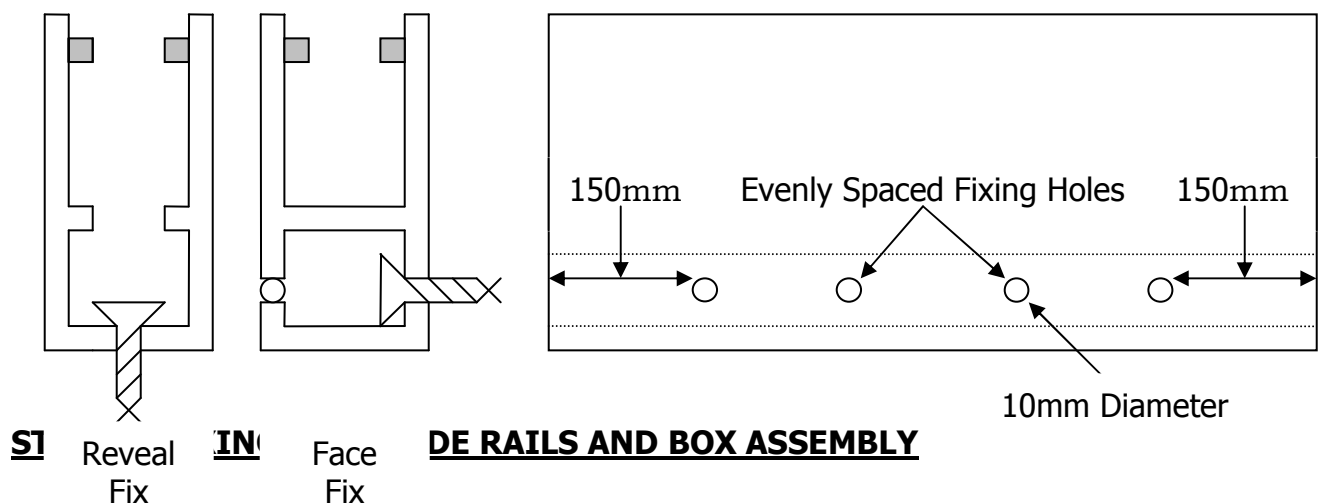

1. Slot the guides onto the end plate pegs, position the box and guides where they are to be fitted. It is vital to level the box assembly and to make sure the guides are square.
2. Fix the guides to the walls making sure they are not distorted in anyway, pack the brickwork out where necessary. Ensure the fixings used are suitable for the wall properties.
3. Drill suitable holes in the end plates to get secure fixings. This can be through the back of the end plate or the end plate side ideally at the top (end of the box assembly). Secure to the walls making sure the box assembly is vertical and follows the line of the guides.
4. Drill and screw the back of the box at regular points along the width of the door. This is best done along the bottom edge or as close to the bottom edge as possible. Make sure all screw heads are flush and not proud as this may damage the surface of the curtain later. **IT IS IMPORTANT TO ENSURE THAT THE CURTAIN IS CLEAR OF THE BACK BOX AND FIXINGS WHEN RUNNING.**

## **STEP 5 – INSTALLING THE EMERGENCY OVERRIDE**

The end plate will have to be drilled according to the desired motor position and associated exit point for the over-ride bar. If you are using a low-level over-ride please refer to separate instructions provided with this.

### **STANDARD INTERNAL OVER-RIDE**

1. Align the manual over-ride bar and eyelet and mark in the end plate where the bar will exit the box. (See Figure 3).
2. Remove a section of endplate or drill a large hole in the required position. We recommend using a stepped drill bit, enlarge hole until the hexagonal bar clears.
3. Shorten bar as necessary.

### **HIGH LEVEL EXTERNAL OVER-RIDE**

1. The endplate will have to be drilled out as for an internal over-ride but this time you will have to exit the box on the outside.
2. For face fitted doors the wall will also have to be drilled. (See Figure 4)

### **LOW LEVEL EXTERNAL OVER-RIDE**

See attached sheet for instructions.

### **EXTERNAL FIT WITH AN EXTERNAL OVERRIDE**

(See figure 5)

**FIGURE 3**  
**INTERNAL OVER-RIDE**

**FIGURE 4**  
**EXTERNAL OVER-RIDE**

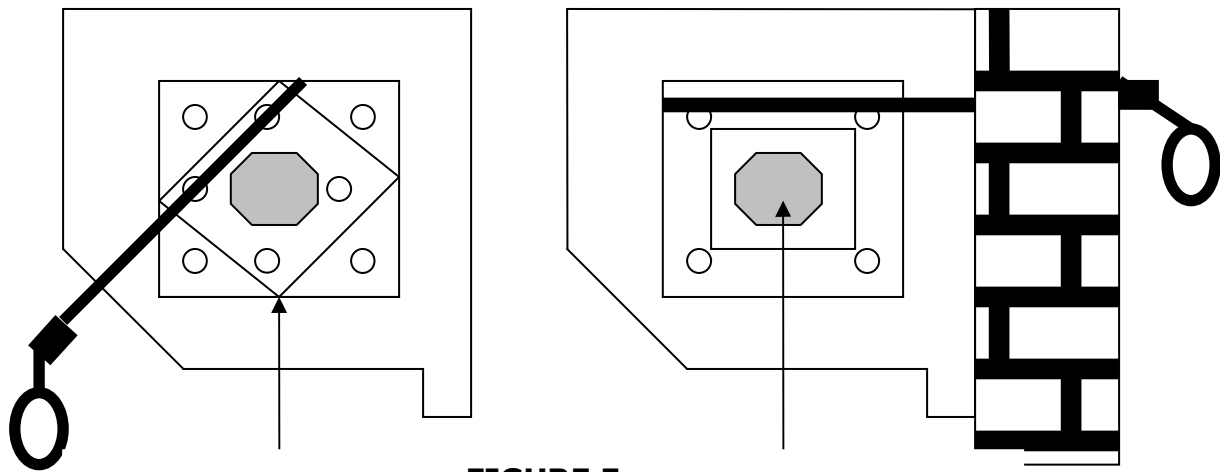

**FIGURE 5**

**EXTERNAL FIT WITH EXTERNAL OVER-RIDE**

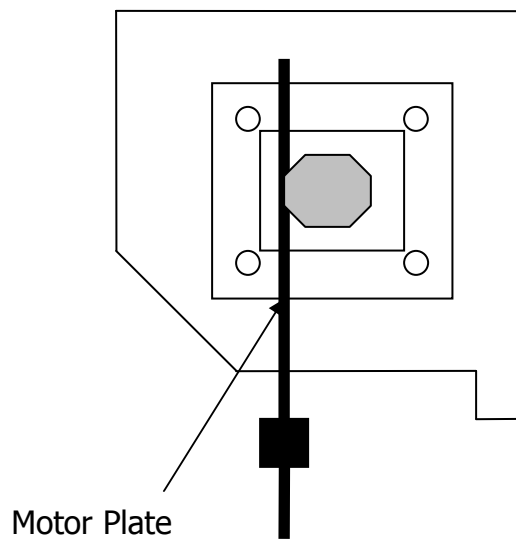

**STEP 6 - FITTING THE REMOTE CONTROL UNIT**

Your door will come with a suitable control unit. This will be packed separately, please follow the instructions, these will be found in the packaging for the control unit box.

## **STEP 7 – INSTALLING THE CURTAIN**

The curtain can be attached to the barrel by “auto-locks” or “T springs”. Before you install the curtain, you must ensure that the motor barrel limit for the close position is set. See step 8.

1. Power up the receiver unit, take a key-fob and press the button. The barrel will rotate in the close direction (approximately two rotations and stop).  
**NOTE:** If the barrel rotation is incorrect, please swap motor direction connections.
2. To ensure the curtain does not get damaged during fitting, the collars on the barrel must be covered with either cardboard or bubble wrap. This can be removed once the curtain is in position.
3. Carefully remove packaging from curtain.
4. Lift the curtain roll and feed the bottom rail over the barrel section into the guide rails. Feed the door into the guide rails approximately half way and unroll the remaining curtain so the curtain is hanging over the barrel.
5. Slide onto the top lathe of the door either the auto-locks or ‘T’ springs provided.
6. Carefully slide the curtain to the closed position.

**NOTE:** In some cases it may be necessary to rotate the barrel to enable fitting of the auto-locks or ‘T’ springs. Do this with the manual over-ride, at this stage do not run the motor.

## **AUTO-LOCKS**

Slip the auto-lock rings onto the location pegs, ensuring that all pegs are in the same hole series. Secure in place with self tapping screws (See Figure 6 and 7). IT IS ADVISED THAT, WITH AN ECONOM MOTOR, A MOTOR WITH SCREW-TURN TYPE LIMITS, YOU ATTACH THE CURTAIN IN STEP 8.

## **FIGURE 6 – AUTOLOCKING RING**

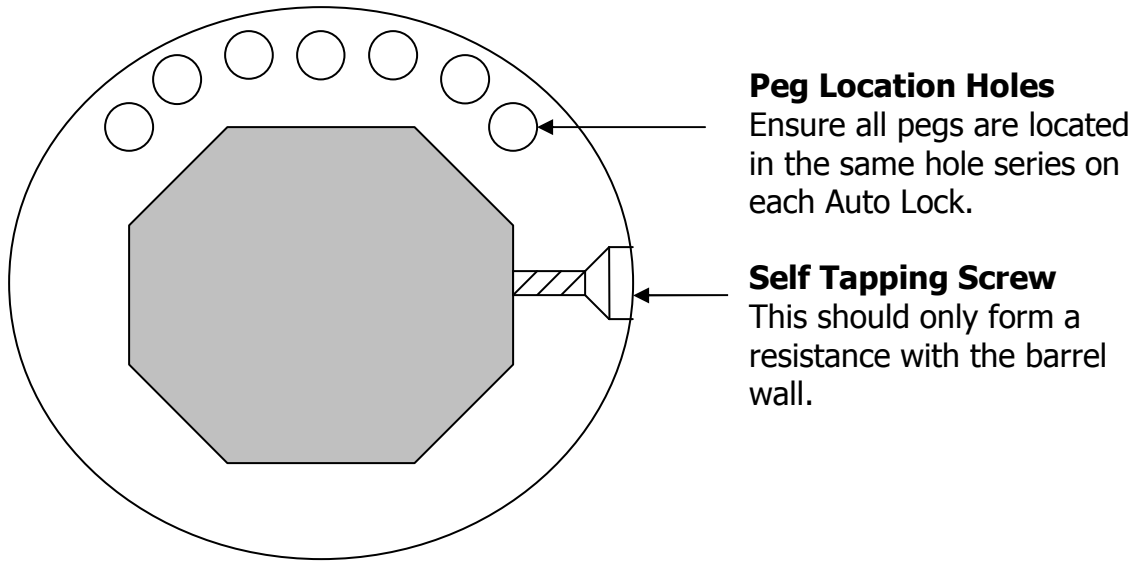

**FIGURE 7 – AUTOLOCKING UNIT**

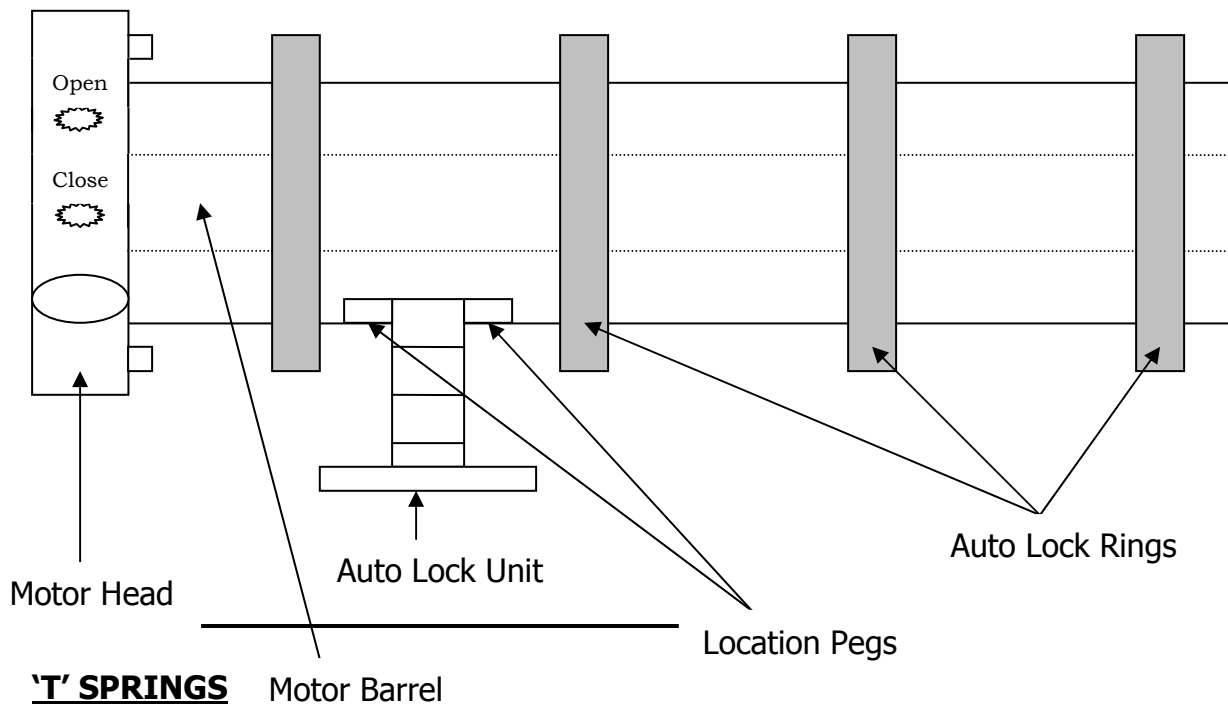

Connect the curtain to the barrel using pop rivets, enlarge the holes in the barrel to accommodate the pop rivets used. Never use the barrel hole directly adjacent to the barrel collars.

### **STEP 8 – SETTING THE MOTOR LIMITS**

Before you operate the door electronically, Easy Fit advise you to open and close the door manually to check operation of the door.

If the motor has screw-type limit switches, the following procedure is to be followed when setting the limits of the motor barrel. Notice that the motor will perform a greater number of revolutions if the screw-limits are opened up by using the + turn of the screw, while the number of revolutions (and thence the opening size of the door) is decreased when the screws are turned in the – direction.

1. Before the curtain is attached to the barrel, send the motor all the way down. This effectively sets the bottom limit. Attach the curtain to the shaft now.

2. You should now find out which screw affects the down and up limits. The down limit screw is indicated by a straight arrow pointing downwards.
3. Now send the curtain up. It should reach its upper limit when the curtain is half way to the desired limit. Stop it with the remote control half way up if it does not stop automatically. Then, make sure the limits are tight at the half way point by turning the up limit in the – direction. You are then in a position to release the curtain's up limit by turning the screw in the + direction. Turn it until the required up position is reached.

**NOTE:** The motor unit has an in-built thermal trip that will activate once the motor unit reaches a predetermined temperature. Repetitive usage during the fine adjustment process can cause the motor to cut out. Please wait approximately fifteen minutes for the unit to return to normal operating mode.

### **STEP 9 – FITTING THE FRONT BOX/ENCLOSURE** (optional)

The front box cover can only be fitted after the motor limits have been set.

1. Clip the internal cover into the back box top retaining lip at approximately 10 degrees.
2. Once the cover is located over it's entire length place the cover hand up against the endplates
3. Drill and fix in place with self tapping screws or pop-rivets
4. Drill a hole in the cover to allow the manual over-ride to be installed. Fix into position with self tapping screws or pop rivets.